



**Shield
Right**

SR6613

SR6613 Portable Emergency Eye Wash 60L

Standard: ANSI Z358.1-2014



Packing List

1. One set of SR6613
2. Metal hook
3. Product Instruction
4. One Reserve Supply Pipe

We are insist to improve products structure and performance, without further notice if any change.

Product Concept

The emergency eye wash is used for washing eyes, face and harmful things on the people's body. Therefore, it is the first aid equipment, but it cannot replace the protect equipment, including the protection for eyes, face and body. It also cannot replace the procedures to deal with dangerous materials. SR6613 Portable Eye Wash is used in areas without a water supply; the maximum water storage is 60L (about 16 gallons).

Location

- In general, the ANSI standard requires that emergency equipment be installed within 10 seconds walking distance from the location of a hazard (approximately 55 feet).
- The equipment must be installed on the same level as the hazard (i.e. accessing the equipment should not require going up or down stairs or ramps).
- The path of travel from the hazard to the equipment should be free of obstructions and as direct as possible.
- The location of the emergency equipment must be marked with a highly visible sign.

Original Water

Drinking water or filtered water.

Hydraulic Pressure

Flow out based on water gravity, the water pressure weakens with the water level drops.
Washing time ≥ 15 minutes.

Training

Simply installing emergency equipment is not sufficient means of ensuring worker safety. It is also very important that employees are trained in the location and proper use of emergency equipment. Research shows that after an incident has occurred, rinsing eyes within the first ten seconds is essential.

- The sooner the injured employee's eyes are rinsed, the lower the risk of damage. Every second is important when preventing permanent damage to save time for medical treatment.
- All employees must be reminded that this equipment is only to be used in emergencies, tampering with the equipment may cause a malfunction.

In emergencies, the afflicted may be unable to open their eyes. Employees may feel pain, anxiousness and loss. They may need others' help to reach the equipment and use it.

- Grab the handle on the back of the water collecting tray and pull it down so that the water collecting tray and the water storage bucket are at 90°. At this time, the built-in eye wash nozzle of the water collecting tray automatically discharges water.
- When liquid sprays, put the injured employee's left hand on the left nozzle, and the right hand on the right nozzle.
- Put the injured employee's head over the eye wash bowl which is hand controlled.
- When rinsing the eyes, use both hands' thumb and index finger to open the eyelids, rinsing for at least 15 minutes.
- After rinsing, seek medical treatment immediately.
- Security and supervisory personnel must be notified that the equipment has been used.

Maintenance

There should be professional staff to take charge of the emergency equipment and do as follows:

- Regularly check the valve, pipe, eye wash nozzle and bowl.
- Clear the obstructions around the equipment.
- Empty the liquid from the equipment every 3-5 days if the equipment is not used for a long time in order to avoid harming the eyes again.

In winter, the emergency equipment must be protected from freezing.

Avoid sudden changes in the equipment's environment to prevent damage and possible malfunction.

Around the emergency equipment there should be adequate lighting so that people can find the equipment in the dark. If necessary, the equipment should be equipped with a warning device, so that other employees can help in an emergency.

SR6613 SR6613 Portable Emergency Eye Wash 60L

Installation Location

- The spray nozzle of the device should be located at a height of at least 838mm from the horizontal level on which the user is standing, but not more than 1143mm, and at least 153mm from the wall or the nearest obstacle.
- Installation location should be reachable within 10 seconds walk from work or hazardous area and there should be no impede on the way. For strong acid and alkali operators, the equipment must be installed next to working position.
- There must be clean visible warning sign and have adequate lighting.
- The metal hook must be able to bear the weight of about 60L (about 16 gallons).



Operation Method

Simply installing emergency equipment is not sufficient means of ensuring worker safety. It is also very important that employees are trained in the location and proper use of emergency equipment. Research shows that after an incident has occurred, rinsing eyes within the first ten seconds is essential.

- The sooner the injured employee's eyes are rinsed, the lower the risk of damage. Every second is important when preventing permanent damage to save time for medical treatment.
- All employees must be reminded that this equipment is only to be used in emergencies, tampering with the equipment may cause a malfunction.

In emergencies, the afflicted may be unable to open their eyes. Employees may feel pain, anxiousness and loss. They may need others' help to reach the equipment and use it.

- Grab the handle on the back of the water collecting tray and pull it down so that the water collecting tray and the water storage bucket are at 90°. At this time, the built-in eye wash nozzle of the water collecting tray automatically discharges water.
- When liquid sprays, put the injured employee's left hand on the left nozzle, and the right hand on the right nozzle.
- Put the injured employee's head over the eye wash bowl which is hand controlled.
- When rinsing the eyes, use both hands' thumb and index finger to open the eyelids, rinsing for at least 15 minutes.
- After rinsing, seek medical treatment immediately
- Security and supervisory personnel must be notified that the equipment has been used.

1 CLOSE STATUS

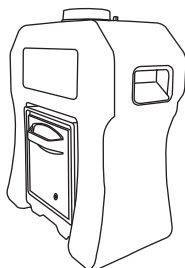

2 OPEN MODE

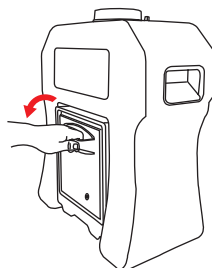

3 USE STATUS



SR6613 SR6613 Portable Emergency Eye Wash 60L

Inspection and maintenance

Safety measures

- The weight of portable eyewash is about 60L(about 16 gallons), when filled with fluid. Providing necessary equipment or personnel to install the filled portable eye wash, or take it off the holder.
- Mount holder to maintain the level of portable eye wash.

Inspection

- Individuals or departments must be arranged to inspect all eye wash devices every week to ensure that the devices are in the correct working conditions and have sufficient flushing fluid. These weekly inspection records should be kept with the device. Devices that only contain water must be cleaned and replenished every 3-5 days. Use of expired liquid may cause serious personal injury.
- **There is a spare water inlet pipe in the plastic bag of each SR6613 portable eye wash device instruction. Customers should pay attention to the wear and aging of the water inlet pipe between the eye wash box and the water bucket according to the frequency of use of their own eye wash. If the water pipe is aging or broken, please replace it in time.**

Replace the flushing fluid in the portable eye wash

1. Remove the portable eye wash from the bracket, open the filling cover, and turn the eye wash upside down to empty all remaining liquid.
2. Rinse the device with pure tap water, stir thoroughly, and then invert the eye wash until the water is drained.
3. Partially fill the device with clean tap water and drain through the eye wash nozzle. If the nozzle is blocked, you can open the nozzle by gently inserting a thin thread or a needle to remove the obstruction. Invert the device to drain any remaining water.
4. Please use drinking water to refill the eye wash.

